

**DMC** DEL MAR COLLEGE  
**Oso Creek Campus**

**7002 Yorktown Blvd.  
Corpus Christi, TX 78414**

- CA** Hospitality and Culinary Institute  
(Culinary Arts)
- MB** Main Central Building  
(includes Library)
- STEM** STEM Building (Science, Technology,  
Engineering, Mathematics)

More maps of Del Mar College campuses and  
locations can be found online:  
[map.delmar.edu](http://map.delmar.edu)

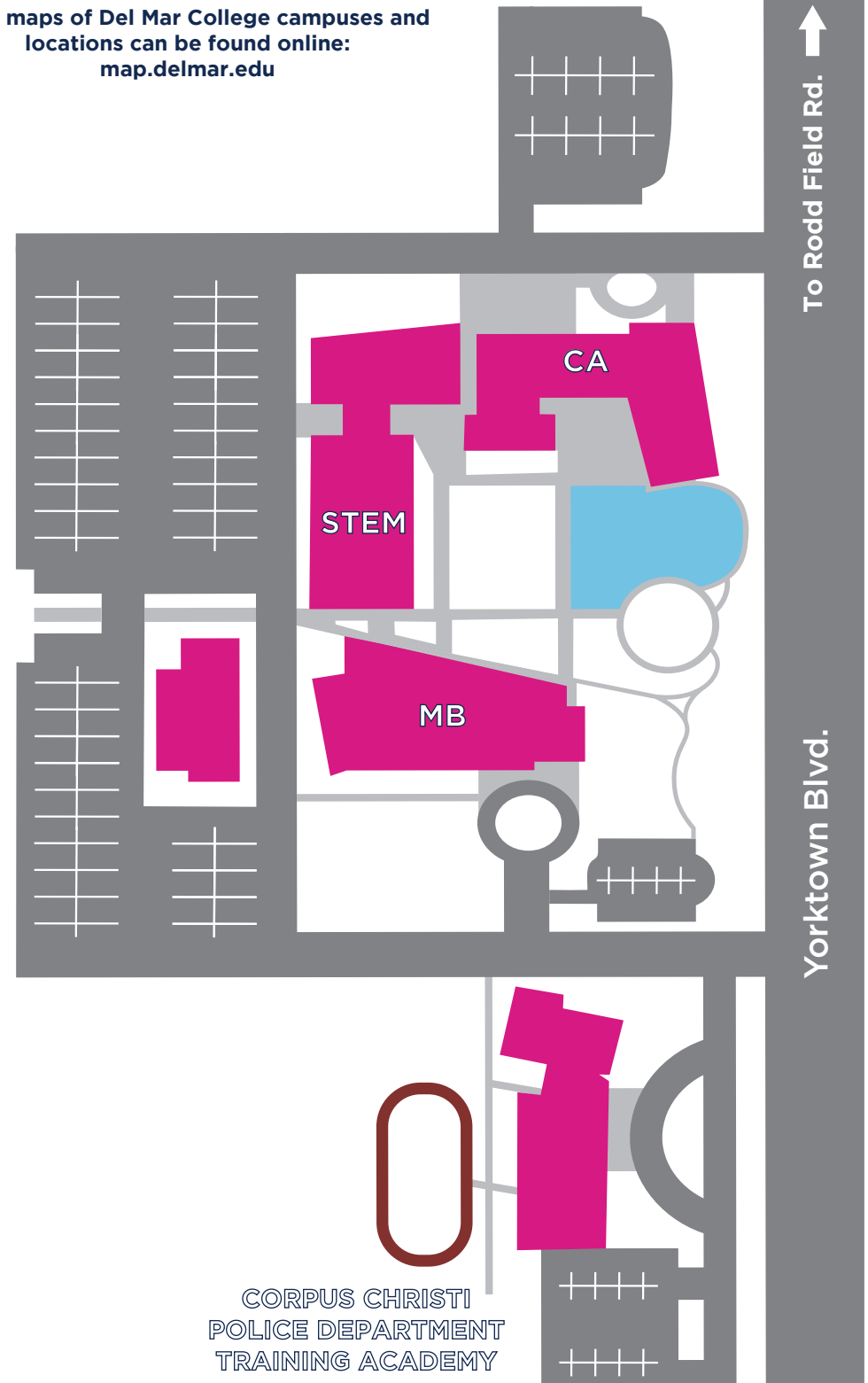

# STUDENT RESOURCES

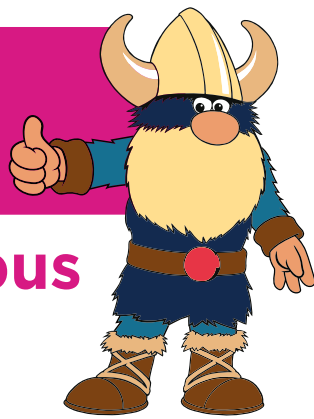

## Oso Creek Campus

### STUDENT SERVICES

#### Financial Aid

(361) 698-1293 | [delmar.edu/afford](http://delmar.edu/afford)

Main Central Building

#### Student Enrollment Center

(361) 698-1290

[delmar.edu/offices/outreach-enrollment](http://delmar.edu/offices/outreach-enrollment)

Main Central Building

#### Student Records Office

(361) 698-1248 | [delmar.edu/records](http://delmar.edu/records)

Main Central Building, Rm. 107

#### Veteran's Services Office

(361) 698-1250 | [delmar.edu/veterans](http://delmar.edu/veterans)

Main Central Building, Rm. 225

#### Testing Center

(361) 698-1645 | [delmar.edu/testing](http://delmar.edu/testing)

Main Central Building, Rm. 312

### STUDENT SUPPORT

#### Center for Access & Advocacy

(361) 698-1948 | [delmar.edu/advocacy](http://delmar.edu/advocacy)

Main Central Building, Rm. 213

#### Student Leadership & Campus Life

(361) 698-1279 | [delmar.edu/offices/campus-life](http://delmar.edu/offices/campus-life)

Main Central Building, Rm. 227

#### Valdar's Market (in partnership with Coastal Bend Food Bank)

(361) 698-2401 | [delmar.edu/market](http://delmar.edu/market)

Main Central Building, Rm. 213

#### Career Development

(361) 698-2692 | [delmar.edu/careerdevelopment](http://delmar.edu/careerdevelopment)

Main Central Building, Rm. 317

#### Counseling Center

(361) 698-1586 | [delmar.edu/counsel](http://delmar.edu/counsel)

Main Central Building, Rm. 212

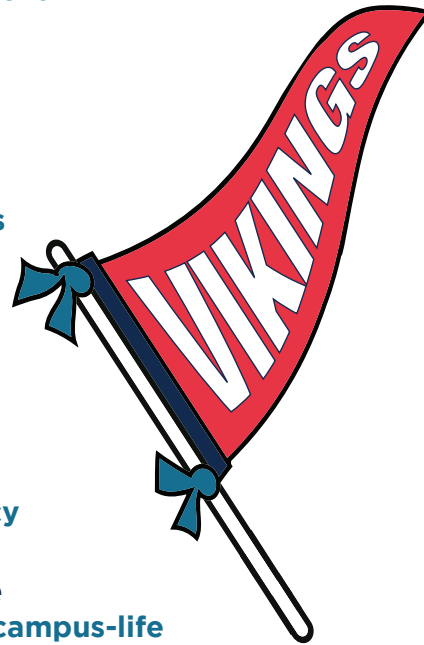

### ACADEMIC RESOURCES

Free tutoring, study spaces, research materials, and technology rentals

#### Oso Creek Library (Attached to OCA)

(361) 698-1048 | [delmar.edu/library](http://delmar.edu/library)

#### Stone Writing Center

(361) 698-1364 | [delmar.edu/swc](http://delmar.edu/swc)

Oso Creek Library, Second Floor

#### Math Learning Center

(361) 698-1579 | [delmar.edu/mlc](http://delmar.edu/mlc)

STEM Building, Rm. 234



## Where can I print?

- Oso Creek Library
- Student Leadership & Campus Life  
*Main Central Building, Rm. 227*
- Math Learning Center  
*STEM Building, Rm. 234*



### TECH TROUBLE? HELP DESK IS HERE FOR YOU!

(361) 698-2330  
[vikinghelpdesk@delmar.edu](mailto:vikinghelpdesk@delmar.edu)  
[delmar.edu/helpdesk](http://delmar.edu/helpdesk)



### ACADEMIC CALENDAR

Scan the QR  
code to view the  
Academic Calendar